

POTENTIOMETER LOCATION DESIGNATIONS

GENERAL NOTES

KEY	
POTENTIOMETER	
•	LOCATED AT TOP FACE
◦	LOCATED AT BOTTOM FACE
→	DIRECTION OUT IS POSITIVE
+	PLYWOOD OOP POT

ABBREVIATIONS	
E	EAST
W	WEST
C	CENTER
UPP	UPPER
MID	MIDDLE
LOW	LOWER
BM	BEAM
COL	COLUMN
GUS	GUSSET
PL	PLATE
ROT	ROTATION
OOP	OUT OF PLANE
CONN	CONNECTION
DISP	DISPLACEMENT
HORIZ	HORIZONTAL
VERT	VERTICAL
MIDPT	MIDPOINT
QRPT	QUARTERPOINT

DESIGNATION

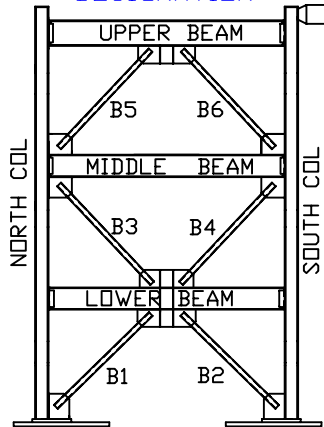

	DESCRIPTION	RANGE +/-	FREEDOM	DESCRIPTION		
1	N ANCHOR PL SLIP	25mm		75	B5 BRACE ELONGATION/OOP DISP	250mm
2	N ANCHOR PL UPLIFT	25mm		76	B6 BRACE ELONGATION/OOP DISP	250mm
3	N BASE PL SLIP	25mm		77	B1 BRACE ELONGATION/OOP DISP	250mm
4	N BASE PL UPLIFT	25mm		78	B2 BRACE ELONGATION/OOP DISP	250mm
				79	B3 BRACE ELONGATION/OOP DISP	250mm
				80	B4 BRACE ELONGATION/OOP DISP	250mm
7A	BOT BM FRAME DRIFT	250mm		81	B5 BRACE ELONGATION/OOP DISP	250mm
8	N SHEAR CONN ROT LOW BM	50mm		82	B6 BRACE ELONGATION/OOP DISP	250mm
9	N SHEAR CONN ROT LOW BM	50mm		83	ACTUATOR BASE PL UPLIFT	25mm
10	LOW BM FRAME DRIFT (DN BM)	250mm		84	ACTUATOR BASE PL SLIP	25mm
12A	MID BM FRAME DRIFT	500mm		87	UPP BM GUS PLYWOOD OOP BOT LEFT	100mm HORIZ
				88	UPP BM GUS PLYWOOD OOP BOT RIGHT	100mm HORIZ
17A	UPP BM FRAME DRIFT	500mm				
				91	MID BM VERT DISP	50mm HORIZ
24	S SHEAR CONN ROT LOW BM	50mm				
25	S SHEAR CONN ROT LOW BM	50mm		94	LOW BM UPP N GUS OOP UPP EDGE	100mm HORIZ
				97	LOW BM UPP S GUS OOP UPP EDGE	100mm HORIZ
28	N ANCHOR PL UPLIFT	25mm		98	LOW BM UPP GUS OOP C	50mm HORIZ
29	N ANCHOR PL SLIP	25mm				
30	N BASE PL UPLIFT	25mm				
31	N BASE PL SLIP	25mm				
32	LOW N GUS OOP UPP EDGE	100mm				
37	LOW S GUS OOP UPP EDGE	100mm				
38	MID BM LOW N GUS OOP LOW EDGE	100mm	HORIZ			
41	MID BM LOW S GUS OOP LOW EDGE	100mm	HORIZ			
46	MID BM UPP N GUS OOP UPP EDGE	100mm	HORIZ			
49	MID BM UPP S GUS OOP UPP EDGE	100mm	HORIZ			
50	UPP BM N GUS OOP LOW EDGE	250mm	HORIZ			
53	UPP BM N GUS OOP LOW EDGE	250mm	HORIZ			
56	UPP BM GUS OOP LOW C	250mm	HORIZ			
57	UPP BM OOP ROT C	250mm	HORIZ			
62	UPP BM OOP ROT N EDGE	250mm	HORIZ			
64	UPP BM OOP ROT N EDGE	250mm	HORIZ			
66	UPP BM VERT DISP	50mm	HORIZ			
71	B1 BRACE ELONGATION/OOP DISP	250mm				
72	B2 BRACE ELONGATION/OOP DISP	250mm				
73	B3 BRACE ELONGATION/OOP DISP	250mm				
74	B4 BRACE ELONGATION/OOP DISP	250mm				

NDI LED LOCATION DESIGNATIONS

DESCRIPTION	RANGE +/-	FREEDOM
N1	LOW BM LOW N GUS OOP LOW EDGE	HORIZ
N2	LOW BM LOW MID GUS OOP LOW EDGE	HORIZ
N3	LOW BM LOW S GUS OOP LOW EDGE	HORIZ
N4	B2 BUCKLED SHAPE	HORIZ
N5	B2 BUCKLED SHAPE	HORIZ
N6	B2 BUCKLED SHAPE	HORIZ
N7	B2 BUCKLED SHAPE	HORIZ
N8	B2 BUCKLED SHAPE	HORIZ
N9	B2 BUCKLED SHAPE	HORIZ
N10	B2 BUCKLED SHAPE	HORIZ
N11	B2 BUCKLED SHAPE	HORIZ
N12	B2 BUCKLED SHAPE	HORIZ
N13	LOW BM OOP ROT N EDGE	HORIZ
N14	LOW BM OOP ROT N EDGE	HORIZ
N15	LOW BM OOP ROT S EDGE	HORIZ
N16	LOW BM OOP ROT S EDGE	HORIZ
N17	LOW BM OOP ROT CENTER	HORIZ
N18	LOW BM LOW N KNIFE PL ROT	HORIZ
N19	LOW BM LOW S KNIFE PL ROT	HORIZ

TCBF2-3 - TOMORROW'S CONCENTRIC BRACED FRAME

NEES/SG NCREC BRACED FRAME TEST INSTRUMENTATION DRAWINGS

DRAWN BY: EJL
 DESIGNED BY: EJL, PCH
 CHECKED BY: N/A
 DATE: May 7, 2009
 CONTACT: CROEDER@U.WASHINGTON.EDU

DWG:

IN-2