

# POTENTIOMETER LOCATION DESIGNATIONS

## GENERAL NOTES

KEY	
POTENTIOMETER	
•	LOCATED AT TOP FACE
◦	LOCATED AT BOTTOM FACE
→	DIRECTION OUT IS POSITIVE
+	PLYWOOD OOP POT

ABBREVIATIONS	
E	EAST
W	WEST
C	CENTER
UPP	UPPER
MID	MIDDLE
LOW	LOWER
BM	BEAM
COL	COLUMN
GUS	GUSSET
PL	PLATE
ROT	ROTATION
OOP	OUT OF PLANE
CONN	CONNECTION
DISP	DISPLACEMENT
HORIZ	HORIZONTAL
VERT	VERTICAL
MIDPT	MIDPOINT
QRPT	QUARTERPOINT

## DESIGNATION

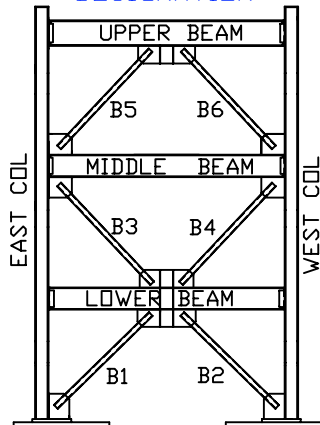

	• DESCRIPTION	RANGE +/-	FREEDOM	• DESCRIPTION		
	1 E ANCHOR PL SLIP	25mm		51 UPP BM E GUS OOP C	100mm	HORIZ
	2 E ANCHOR PL UPLIFT	25mm		52 UPP BM E GUS OOP EAST EDGE	150mm	HORIZ
	3 E BASE PL SLIP	25mm		53 UPP BM E GUS OOP LOW EDGE	150mm	HORIZ
	4 E BASE PL UPLIFT	25mm		54 UPP BM E GUS OOP C	100mm	HORIZ
				55 UPP BM E GUS OOP W EDGE	150mm	HORIZ
				56 UPP BM GUS OOP LOW C	100mm	HORIZ
7A	7 BOT BM FRAME DRIFT	300mm		57 UPP BM OOP ROT C	150mm	HORIZ
	8 E SHEAR CONN ROT LOW BM	50mm				
	9 E SHEAR CONN ROT LOW BM	50mm				
12A	12 MID BM FRAME DRIFT	400mm		62 UPP BM OOP ROT E EDGE	25mm	HORIZ
				63 UPP BM OOP ROT E EDGE	25mm	HORIZ
				64 UPP BM OOP ROT W EDGE	25mm	HORIZ
				65 UPP BM OOP ROT W EDGE	25mm	HORIZ
				66 UPP BM VERT DISP	250mm	HORIZ
17A	17 UPP BM FRAME DRIFT	500mm				
				71 B1 BRACE DIAGONAL/OOP DISP	250mm	
				72 B2 BRACE DIAGONAL/OOP DISP	250mm	
				73 B3 BRACE DIAGONAL/OOP DISP	250mm	
				74 B4 BRACE DIAGONAL/OOP DISP	250mm	
				75 B5 BRACE DIAGONAL/OOP DISP	250mm	
				76 B6 BRACE DIAGONAL/OOP DISP	250mm	
				77 B1 BRACE DIAGONAL/OOP DISP	250mm	HORIZ
				78 B2 BRACE DIAGONAL/OOP DISP	250mm	HORIZ
				79 B3 BRACE DIAGONAL/OOP DISP	250mm	HORIZ
				80 B4 BRACE DIAGONAL/OOP DISP	250mm	HORIZ
				81 B5 BRACE DIAGONAL/OOP DISP	250mm	HORIZ
				82 B6 BRACE DIAGONAL/OOP DISP	250mm	HORIZ
				83 ACTUATOR BASE PL UPLIFT	25mm	
				84 ACTUATOR BASE PL SLIP	25mm	
				85 B5 OOP DISP AT QRPT	250mm	HORIZ
				86 B6 OOP DISP AT QRPT	250mm	HORIZ
				87 UPP BM GUS PLYWOOD OOP BOT LEFT	100mm	HORIZ
				88 UPP BM GUS PLYWOOD OOP BOT RIGHT	100mm	HORIZ
				89 UPP BM GUS PLYWOOD OOP TOP LEFT	100mm	HORIZ
				90 UPP BM GUS PLYWOOD OOP TOP RIGHT	100mm	HORIZ
				91 MID BM VERT DISP	150mm	HORIZ
				92 LOW BM UPP E GUS OOP E EDGE	100mm	HORIZ
				93 LOW BM UPP E GUS OOP C	150mm	HORIZ
				94 LOW BM UPP E GUS OOP UPP EDGE	150mm	HORIZ
				95 LOW BM UPP W GUS OOP W EDGE	100mm	HORIZ
				96 LOW BM UPP W GUS OOP C	150mm	HORIZ
				97 LOW BM UPP W GUS OOP UPP EDGE	150mm	HORIZ
				98 LOW BM UPP GUS OOP C	150mm	HORIZ
	24 W SHEAR CONN ROT LOW BM	50mm				
	25 W SHEAR CONN ROT LOW BM	50mm				
	26 W COL ROT AT LOW GUS EDGE	50mm				
	27 W COL ROT AT LOW GUS EDGE	25mm				
	28 E ANCHOR PL UPLIFT	25mm				
	29 E ANCHOR PL SLIP	25mm				
	30 E BASE PL UPLIFT	25mm				
	31 E BASE PL SLIP	25mm				
	32 LOW E GUS OOP UPP EDGE	150mm				
	33 LOW E GUS OOP C	100mm				
	34 LOW E GUS OOP W EDGE	150mm				
	35 LOW W GUS OOP E EDGE	150mm				
	36 LOW W GUS OOP C	100mm				
	37 LOW W GUS OOP UPP EDGE	150mm				
	38 MID BM LOW E GUS OOP LOW EDGE	150mm	HORIZ			
	39 MID BM LOW E GUS OOP C	100mm	HORIZ			
	40 MID BM LOW E GUS OOP W EDGE	150mm	HORIZ			
	41 MID BM LOW W GUS OOP LOW EDGE	150mm	HORIZ			
	42 MID BM LOW W GUS OOP C	100mm	HORIZ			
	43 MID BM LOW W GUS OOP E EDGE	150mm	HORIZ			
	44 MID BM UPP E GUS OOP W EDGE	150mm	HORIZ			
	45 MID BM UPP E GUS OOP C	100mm	HORIZ			
	46 MID BM UPP E GUS OOP UPP EDGE	150mm	HORIZ			
	47 MID BM UPP W GUS OOP E EDGE	150mm	HORIZ			
	48 MID BM UPP W GUS OOP C	100mm	HORIZ			
	49 MID BM UPP W GUS OOP UPP EDGE	150mm	HORIZ			
	50 UPP BM E GUS OOP LOW EDGE	150mm	HORIZ			

TCBF4 – TOMORROW'S CONCENTRIC BRACED FRAME 4

NEES/SG NCREE BRACED FRAME TEST INSTRUMENTATION DRAWINGS

DRAWN BY: E.JL, KAC  
 DESIGNED BY: E.JL, KAC  
 CHECKED BY: N/A  
 DATE: JANUARY 2, 2009  
 CONTACT: CROEDER@U.WASHINGTON.EDU

DWG:

IN-2